

## The PlayWell Group, Inc.

**Doug Stults**  
Sales consultant

Dallas  
972-488-9355

Toll free  
800-726-1816

Toll free fax  
800-562-9150

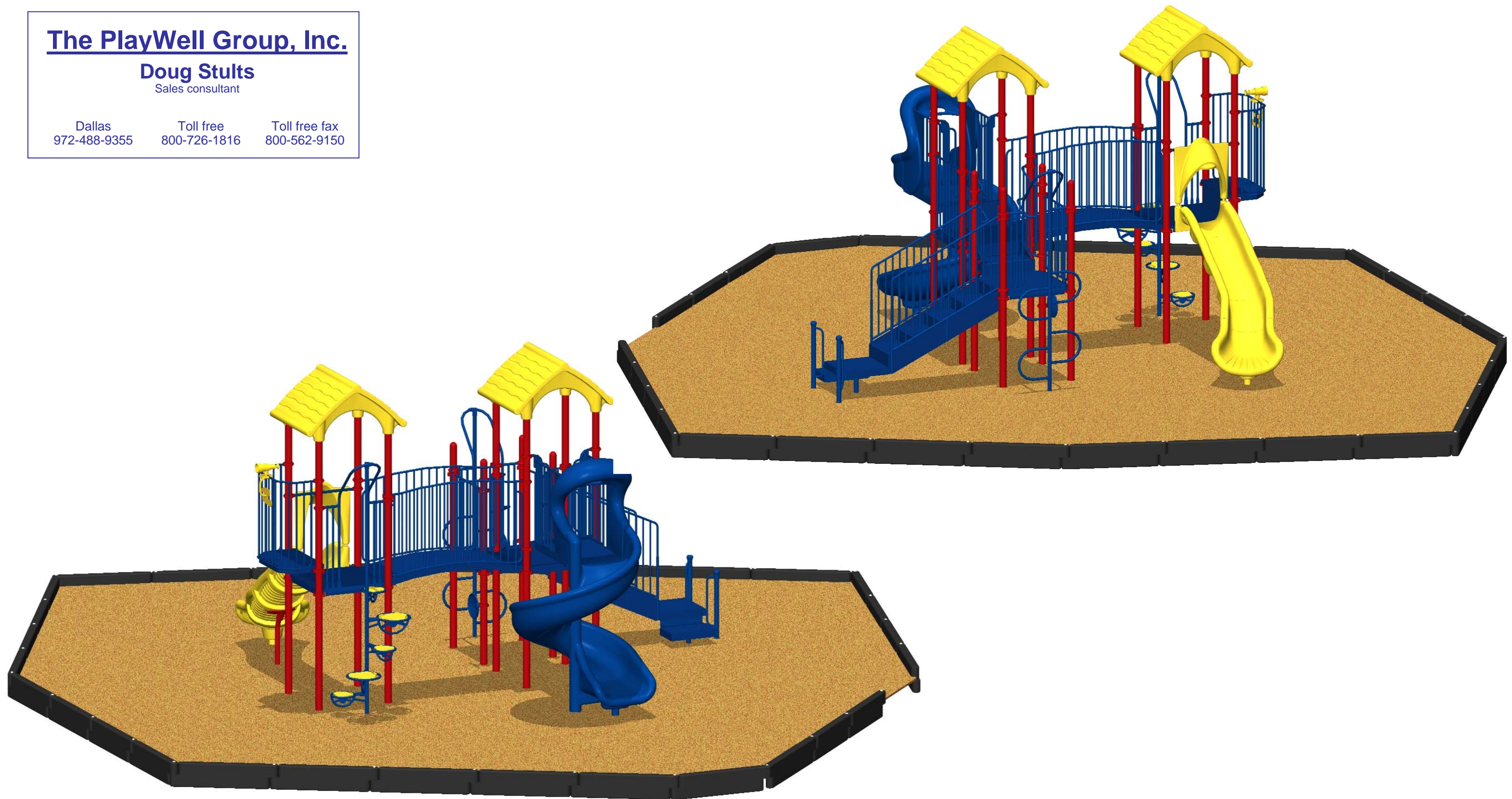

# PEBBLE CREEK

**Challengers**

C40617B

[www.playwellgroup.com](http://www.playwellgroup.com)



# The PlayWell Group



"Everything in a park  
that doesn't grow."



- 1) This play system meets or exceeds the requirements for access under the Accessibility Guidelines for Play Areas developed by the Federal Access Board when installed over accessible surfacing.
- 2) This site plan should be checked against the actual site area prior to the purchase or installation of equipment.



## 2005 CHALLENGERS

### COMPLIES WITH:

- ☒ ASTM F1487-01
- ☐ ASTM F1487-98
- ☒ CPSC #325
- ☒ ADA - ADAAG
- ☐ CSA Z614-03

### TOWER DETAIL

|             |               |
|-------------|---------------|
| PROJECT NO: | REV:          |
| C40617      | B             |
| DATE:       | 3/3/2006      |
| SCALE:      | SEE BAR SCALE |
| DRAWN BY:   | David Miller  |

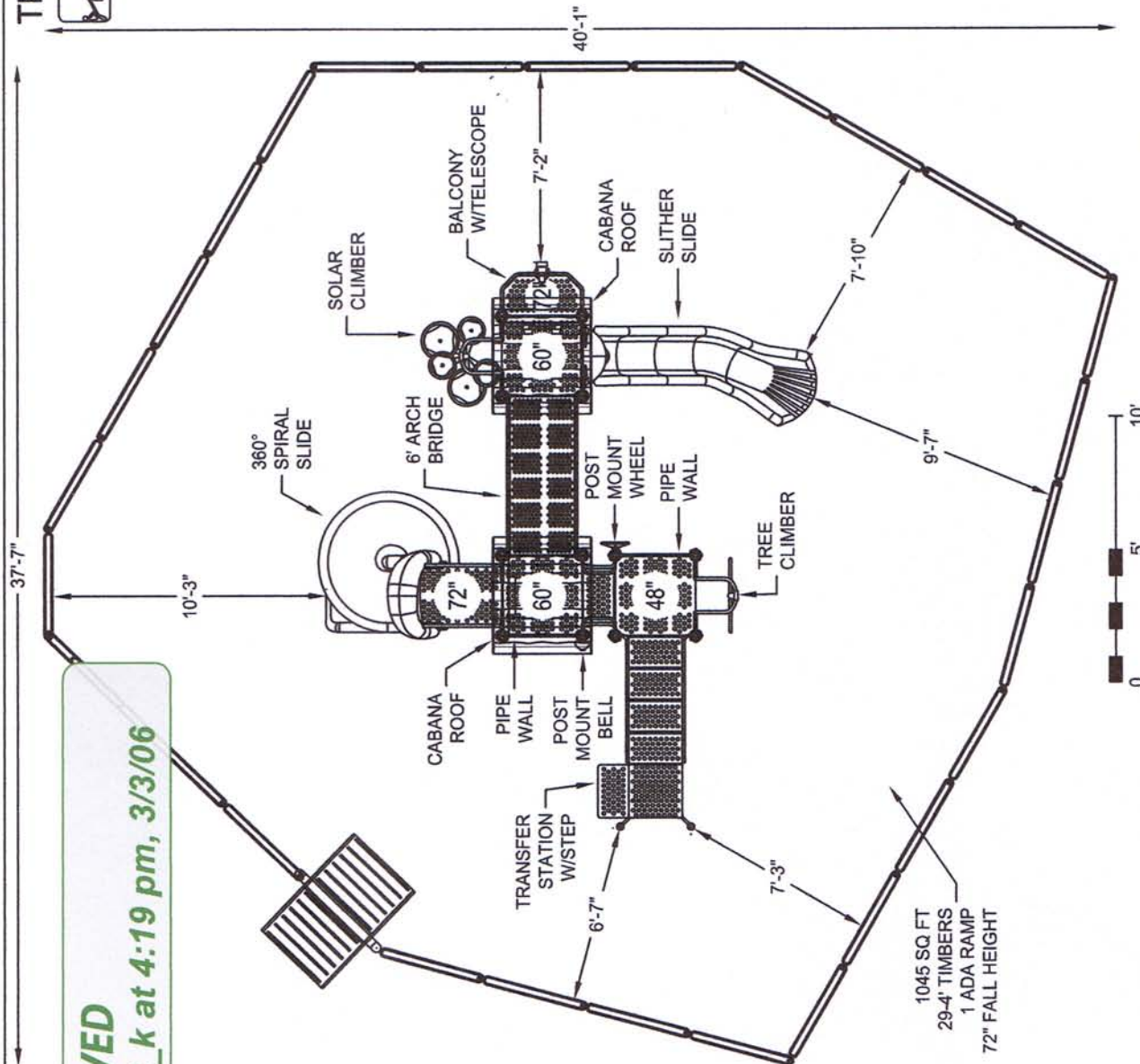

**APPROVED**

By Scott\_k at 4:19 pm, 3/3/06

Doug Stults  
The PlayWell Group  
800-726-1816

## PEBBLE CREEK

Ages 2 - 12

**PLAYWORLD™**  
When trust matters™

© 2004 Playworld Systems, Inc.  
Playworld® is a brand of Playworld Systems, Inc.



**The PlayWell Group, Inc.**

**Doug Stults**

Sales consultant

Dallas  
972-488-9355

Toll free  
800-726-1816

Toll free fax  
800-562-9150







"Everything in a park  
that doesn't grow."

- 1) This play system meets or exceeds the requirements for access under the Accessibility Guidelines for Play Areas developed by the Federal Access Board when installed over accessible surfacing.
- 2) This site plan should be checked against the actual site area prior to the purchase or installation of equipment.



**APPROVED**

By Scott Johnson at 11:55 pm, 2/28/06

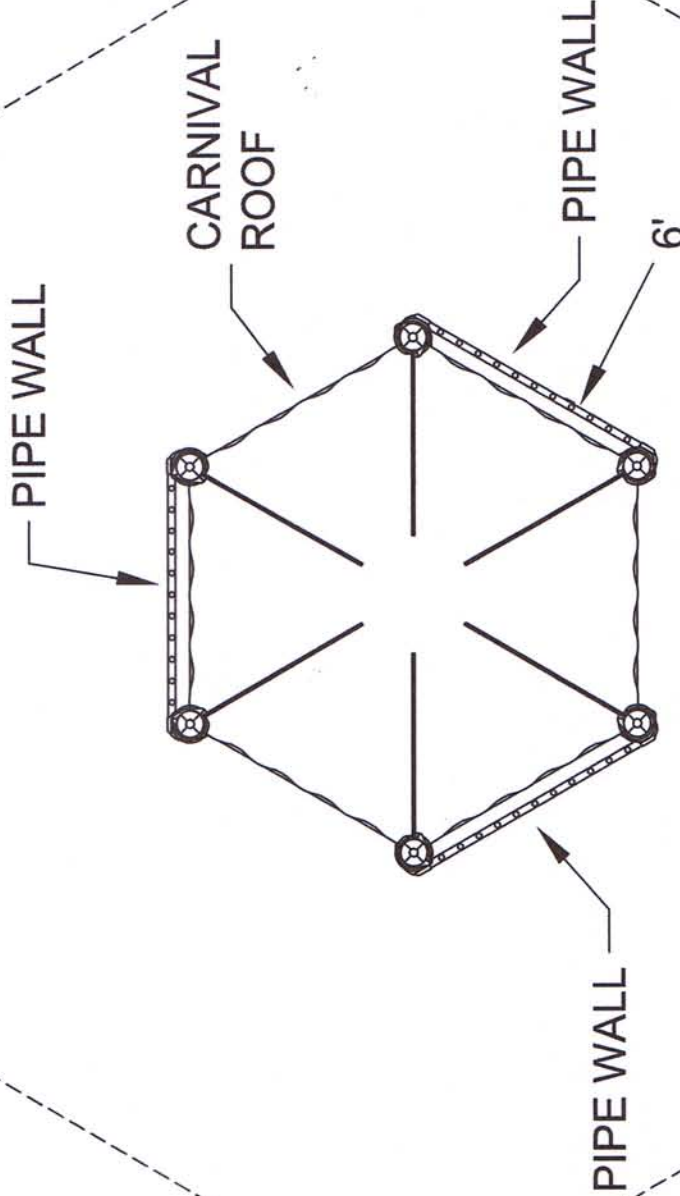

2005  
**PLAYMAKERS**

COMPLIES WITH:

- ☒ ASTM F1487-01
- ☐ ASTM F1487-98
- ☒ CPSC #325
- ☒ ADA - ADAAG
- ☐ CSA Z614-03

TOWER DETAIL

|             |               |
|-------------|---------------|
| PROJECT NO: | REV:          |
| P40602      | A             |
| DATE:       | 2/28/2006     |
| SCALE:      | SEE BAR SCALE |
| DRAWN BY:   | David Miller  |

Doug Stultis  
The PlayWell Group  
800-726-1816

**FOREST RIDGE**

Ages 5 - 12

**PLAYWORLD™**  
When trust matters™

© 2004 Playworld Systems, Inc.  
Playworld™ is a brand of Playworld Systems, Inc.



"Everything in a park  
that doesn't grow."

- 1) This play system meets or exceeds the requirements for access under the Accessibility Guidelines for Play Areas developed by the Federal Access Board when installed over accessible surfacing.
- 2) This site plan should be checked against the actual site area prior to the purchase or installation of equipment.



## 2005 CHALLENGERS

### COMPLIES WITH:

- ☒ ASTM F1487-01
- ☐ ASTM F1487-98
- ☒ CPSC #325
- ☒ ADA - ADAAG
- ☐ CSA Z614-03

### TOWER DETAIL

|              |               |
|--------------|---------------|
| PROJECT NO:  | REV:          |
| C40618       | A             |
| DATE:        | SCALE:        |
| 3/1/2006     | SEE BAR SCALE |
| DRAWN BY:    |               |
| David Miller |               |

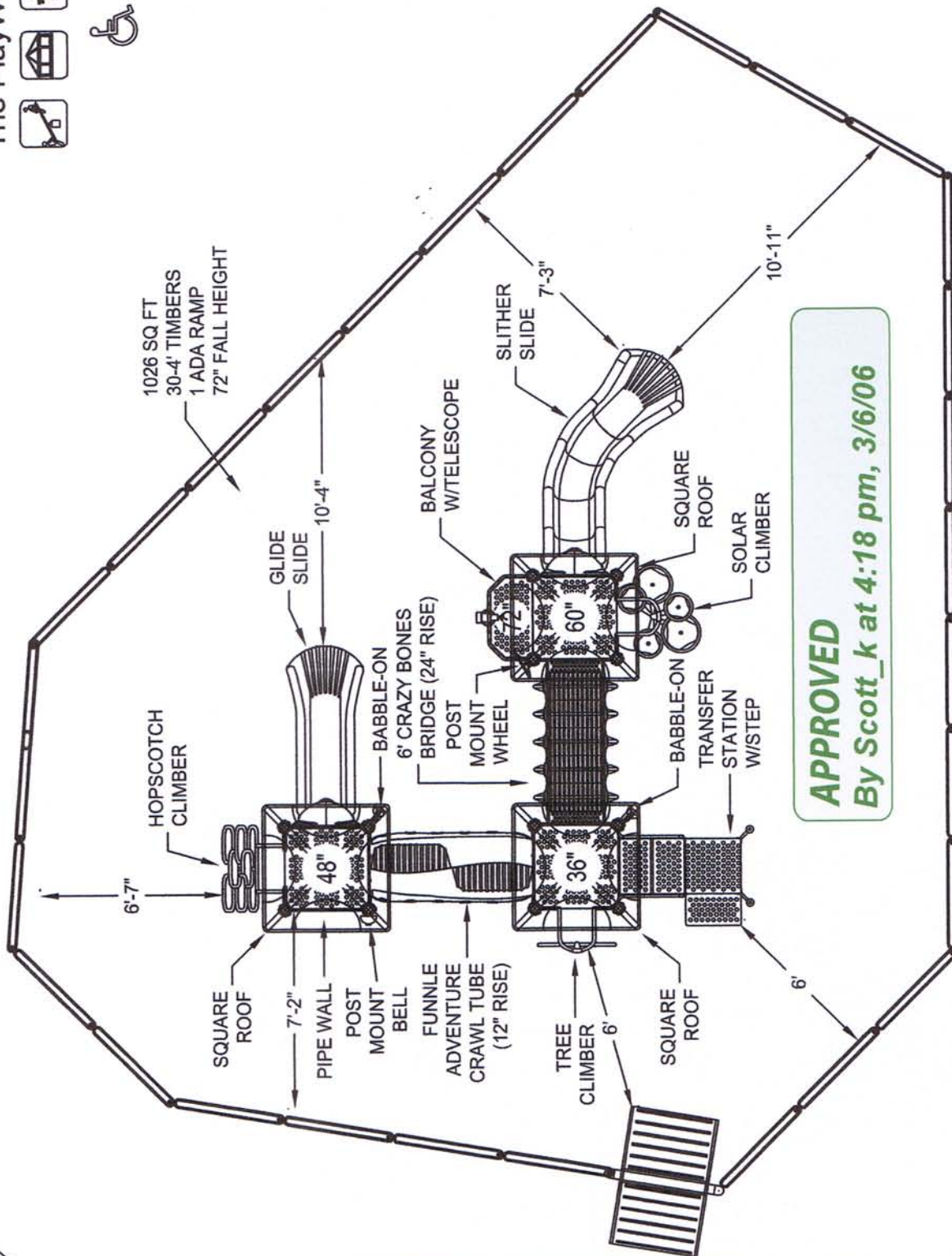

**APPROVED**  
By Scott\_k at 4:18 pm, 3/6/06



**PLAYWORLD™**  
When trust matters™

© 2004 Playworld Systems, Inc.  
Playworld® is a brand of Playworld Systems, Inc.

**SOUTHWOOD VALLEY**

Doug Stults  
The PlayWell Group  
800-726-1816

Ages 2 - 12

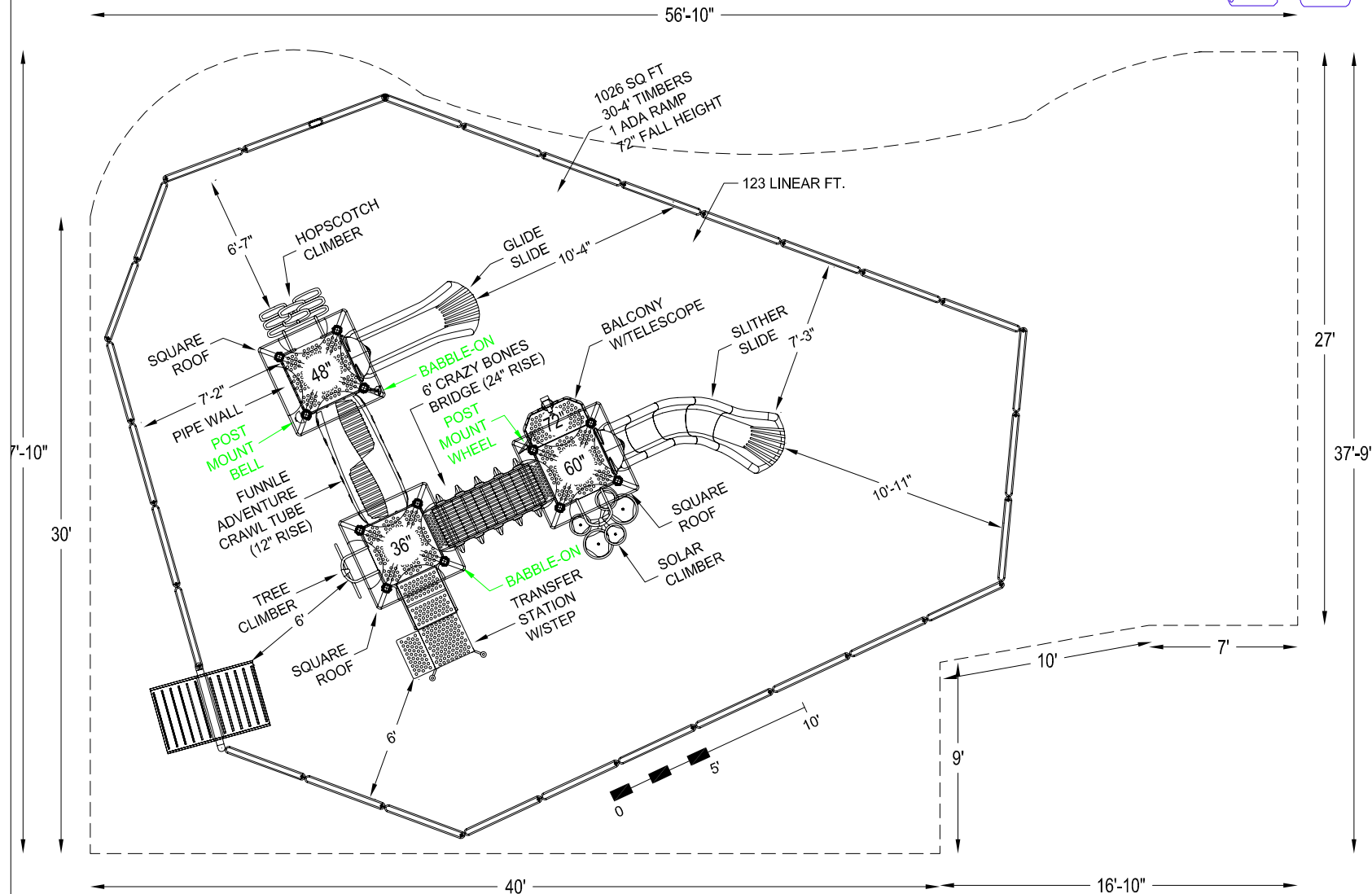

## 2006 SITE PLAN

### COMPLIES WITH:

- ☒ ASTM F1487-01
- ☐ ASTM F1487-98
- ☒ CPSC #325
- ☒ ADA - ADAAG
- ☐ CSA Z614-03

### TOWER DETAIL

PROJECT NO:  
**S40606**

REV:  
**A**

DATE:  
**03-16-06**

SCALE:  
**SEE BAR SCALE**

DRAWN BY:  
**Travis Miller**



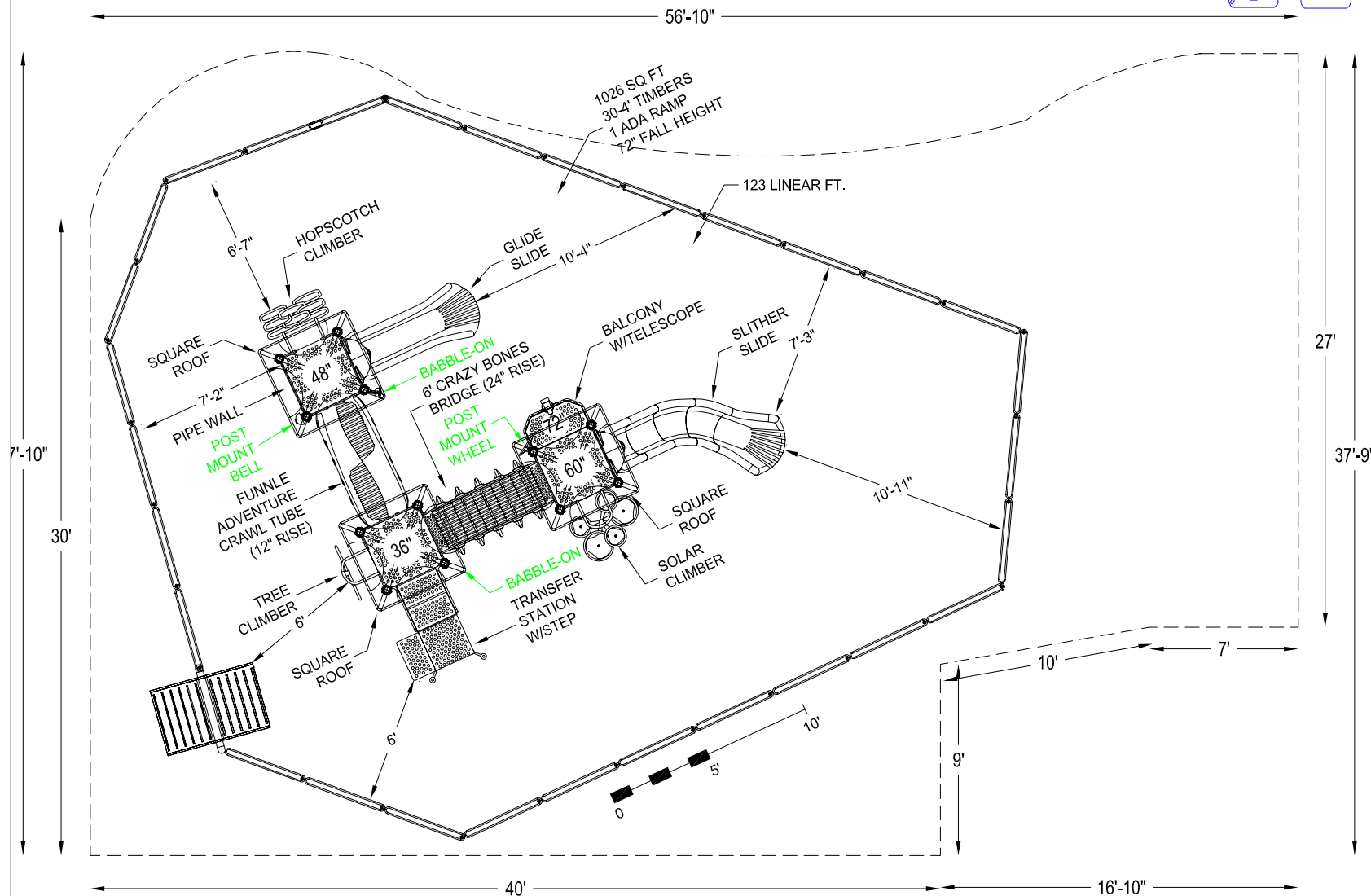

## 2006 SITE PLAN

### COMPLIES WITH:

- ☒ ASTM F1487-01
- ☐ ASTM F1487-98
- ☒ CPSC #325
- ☒ ADA - ADAAG
- ☐ CSA Z614-03

### TOWER DETAIL

|               |      |
|---------------|------|
| PROJECT NO:   | REV: |
| S40606        | A    |
| DATE:         |      |
| 03-16-06      |      |
| SCALE:        |      |
| SEE BAR SCALE |      |
| DRAWN BY:     |      |
| Travis Miller |      |

## The PlayWell Group, Inc.

**Doug Stults**  
Sales consultant

Dallas  
972-488-9355

Toll free  
800-726-1816

Toll free fax  
800-562-9150



# SOUTHWOOD VALLEY

**Challengers**

C40618B

[www.playwellgroup.com](http://www.playwellgroup.com)



## The PlayWell Group, Inc.

**Doug Stults**

Sales consultant

Dallas  
972-488-9355

Toll free  
800-726-1816

Toll free fax  
800-562-9150



# SOUTH KNOLL ELEMENTARY

**Challengers**

C40616A

[www.playwellgroup.com](http://www.playwellgroup.com)

# The PlayWell Group



"Everything in a park  
that doesn't grow."

442 SQ FT  
78-4' TIMBERS



- 1) This play system meets or exceeds the requirements for access under the Accessibility Guidelines for Play Areas developed by the Federal Access Board when installed over accessible surfacing.
- 2) This site plan should be checked against the actual site area prior to the purchase or installation of equipment.



## 2005 SITE PLAN

### COMPLIES WITH:

- ☒ ASTM F1487-01
- ☐ ASTM F1487-98
- ☒ CPSC #325
- ☒ ADA - ADAAG
- ☐ CSA Z614-03

### TOWER DETAIL

|                       |           |
|-----------------------|-----------|
| PROJECT NO:<br>S40604 | REV:<br>A |
|-----------------------|-----------|

|                   |
|-------------------|
| DATE:<br>3/7/2006 |
|-------------------|

|                         |
|-------------------------|
| SCALE:<br>SEE BAR SCALE |
|-------------------------|

|                           |
|---------------------------|
| DRAWN BY:<br>David Miller |
|---------------------------|

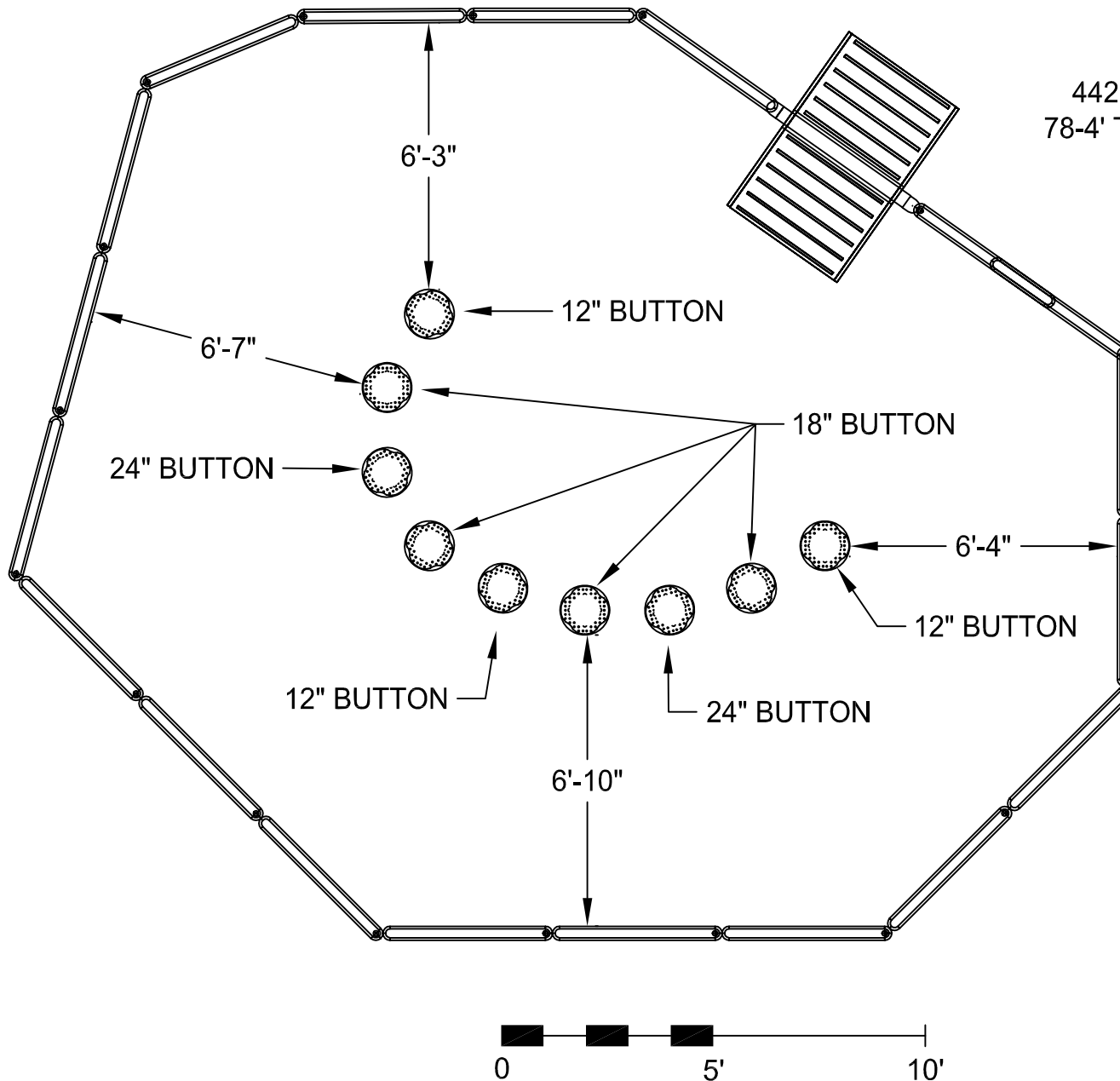

**PLAYWORLD**  
When trust matters™

© 2004 Playworld Systems, Inc.  
Playworld™ is a brand of Playworld Systems, Inc.

## SOUTH KNOLL ELEMENTARY

Ages 5 - 12

Doug Stults  
The PlayWell Group  
800-726-1816





"Everything in a park has doesn't grow."

**APPROVED**

By Scott Johnson at 11:58 pm, 2/28/06

- 1) This play system meets or exceeds the requirements for access under the Accessibility Guidelines for Play Areas developed by the Federal Access Board when installed over accessible surfacing.
- 2) This site plan should be checked against the actual site area prior to the purchase or installation of equipment.

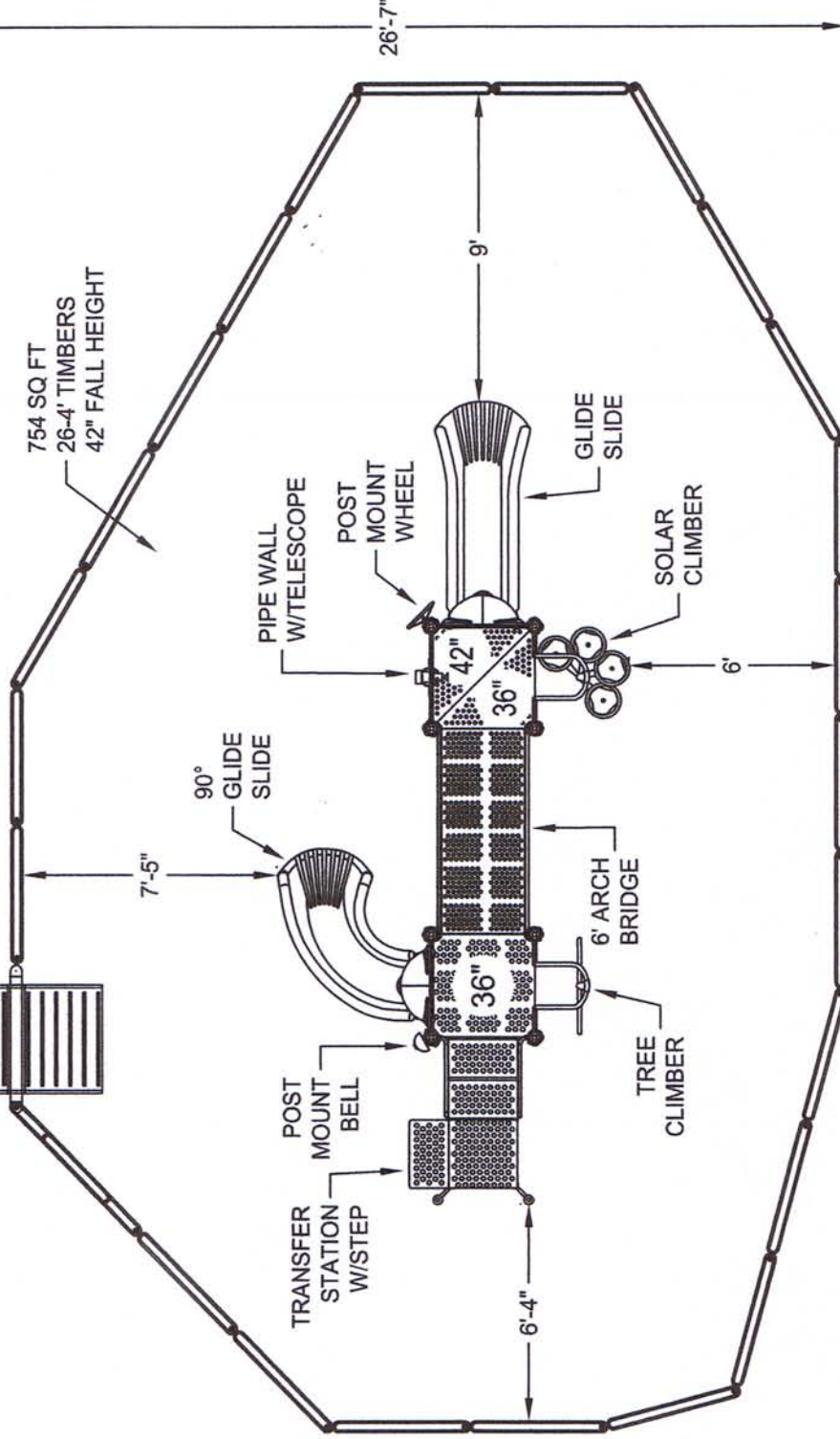

2005

## CHALLENGERS

### COMPLIES WITH:

- ☒ ASTM F1487-01
- ☐ ASTM F1487-98
- ☒ CPSC #325
- ☒ ADA - ADAAG
- ☐ CSA Z614-03

### TOWER DETAIL

|             |               |
|-------------|---------------|
| PROJECT NO: | REV:          |
| C40616      | A             |
| DATE:       | 2/28/2006     |
| SCALE:      | SEE BAR SCALE |
| DRAWN BY:   | David Miller  |

Doug Stultis  
The PlayWell Group  
800-726-1816

## SOUTH KNOLL

Ages 2 - 12

**PLAYWORLD™**  
When trust matters™  
© 2006 Playworld Systems, Inc.  
Playworld is a brand of Playworld Systems, Inc.